

Lift and lock steel hinged support rail with toilet roll holder



Product details

Warranty: 2 years

Max rated load: 115 kg

Doc M compliant: Yes (800mm variant only)

Suitable for wet areas: No

Features

- Lift and lock folding mechanism
- Integral toilet roll holder
- Robust steel construction
- Durable epoxy polyester coating
- Complies with Part M of the Building Regulations (800mm variant only)

Finish options

WH

White
RAL 9016

DB

Dark blue
RAL 5011

DG

Dark grey
RAL 7016

GY

Grey
RAL 7005

Product description

Trombone lift and lock hinged support rail, steel, toilet roll holder, 550mm

Trombone lift and lock hinged support rail, steel, toilet roll holder, 800mm

Product code

112055/**

DDGR-B/**

Replace ** with finish option code above e.g., DDGR-B/DB

Disclaimer

NYMAS Group makes every effort to ensure that the information provided on this data sheet is correct. However, we cannot guarantee this, and accept no liability for any information or advice given on this data sheet.

Dimensions (mm)

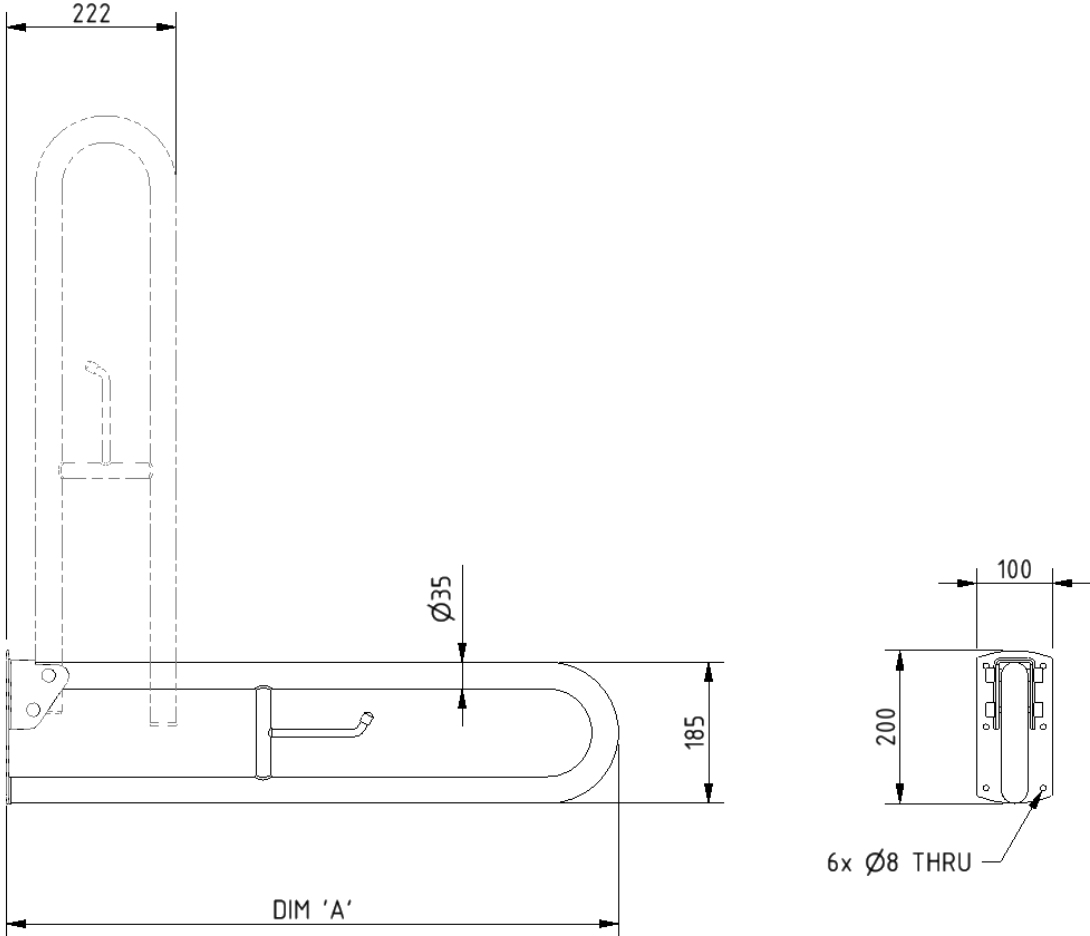

| | | |
|--------------|-----------|-----------|
| PRODUCT CODE | 112055/** | DDGR-B/** |
| DIM 'A' | 550 | 800 |