

# COAT HOOK (URBAN METAL SERIES)



PXB-UM



Plain

Black



## Features

- A deceptively simple design emphasizing modern urban sensibilities. The edges have been gently rounded and the surface has been carefully and delicately processed.
- Metal core provides durability and high load capacity.
- The matte black finish is coated with a special chromate. This type combines the desirable glossiness of paint with the unique strength of plating.
- A wide array of matching products are available, allowing for total design coordination.

## Parts Included

- Pan head tapping screw 4x32
- Hexagon socket countersunk head screw M4x8

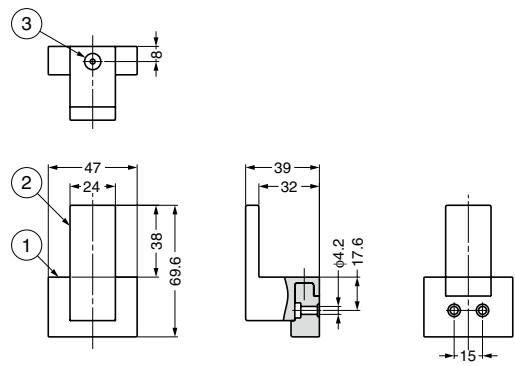

No.	Part Name	Material	Finish
①	Base	Aluminium	Anodized
②	Arm	Aluminium	Anodized
③	Socket Screw	Stainless Steel	Painting

Item Code	Item Name	Colour	Load Capacity		Weight(g)	Box(pcs)	Carton(pcs)
110-033-272	PXB-UM05-101-ST	Plain	98 N	10 kgf	112	8	80
110-033-273	PXB-UM05-101-BL	Black			112	8	80